



www.OnHeatherHill.com

An Old World Estate For Today's Active Lifestyle

Lakewood, Washington

**OFFERED
FOR SALE**





*There are certain places where art and
architecture become one.*



The Architect for Heather Hill was Kirtland Cutter who designed the home with an asymmetrical concept.

It was designed to be reminiscent of Old Cotswold England. The feeling that the home was created over time and added onto over the years was intentional.

Cutter had an amazing life and actually studied art in Europe. He came to create the great commercial buildings, hotels and grand residences of the Northwest. He designed such area landmarks as the Thornewood Castle and Villa Madera where actress Linda Evans once lived.

Heather Hill was built for the Dolge Family, an active player in the area timber industry. Cutter saw the heather and aptly named the home, Heather Hill.





The restoration by the current owners has brought the home back to its original glory.

Modern conveniences have been put in place to accommodate an active lifestyle for today, yet being sensitive and thoughtful to the period and essence of the home.

Tremendous care was given to the tiles, luxurious Rohl plumbing fixtures and the handcrafted glass mosaics. Modern necessities like monitored smoke detectors and equipping the home for plasma televisions are done and ready for you.

Careful research, artisan style and execution make the home a timeless classic.





The Lifestyle

Living on Heather Hill is a true escape. Everywhere you turn you are reminded of the romance of a time gone by. You are reminded of when life was slower.

You realize that what is important is the gathering of family and friends. Living here means that you appreciate the conversation on a flagstone terrace while gazing into the reflections of the lake. You must also appreciate the history of Lakewood, the charm of the period, and the gathering and entertaining of family and friends in a lakeside setting.















- 2.47 Acres with 138' Waterfront
- About 5703 Square Feet
- 1 Bedroom Apartment over Garage
- 3 Car Garage
- Outdoor Living and Dining Rooms
- Media Room
- Boat House
- Interiors collaborated with Larry Hook
- Grandfathered for irrigation rights from the lake
- Gravel walk in beach



- 11430 Gravelly Lake Drive SW., Lakewood, WA
- Sothebysrealty.com ID #4166137
- MLS #29038600
- Streaming Video and more information online at www.OnHeatherHill.com



Lower Level



First Level Garage

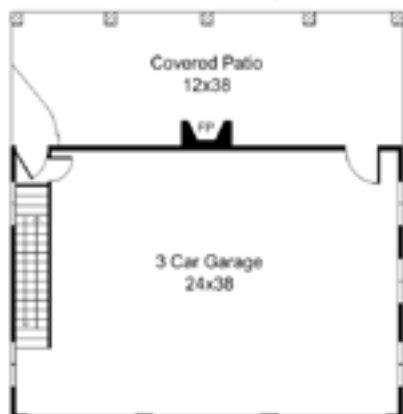

Level Above Garage



Main Level



Upper Level





MICHAEL MORRISON
THE UNIQUE HOME SPECIALIST

C 253.606.5925

E MICHAEL@MYUNIQUEHOME.COM

Morrison
House

Sotheby's
INTERNATIONAL REALTY

LAKWOOD'S #1 WATERFRONT BROKER
NAMED BEST AGENT MARKETING IN THE U.S.

ONHEATHERHILL.COM
FOR MORE INFORMATION
AND STREAMING VIDEO

